

5 sovrum Villa till salu i Benahavis, Málaga

4.250.000€

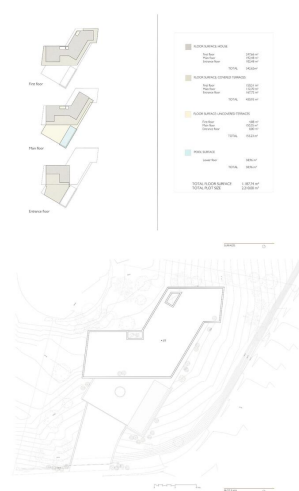

NEW BUILD LUXURY VILLA IN BENAHAIVIS

Perched on an elevated position in the mountain foothills, New Build Luxury Villa is a masterful blend of strategic design and playful space distribution. With its back embraced by the mountain and its front opening to breath taking views.

The architecture and outdoor spaces are meticulously oriented towards the Mediterranean Sea, the castle of Monte Mayor, and the emerald valley below. From the expansive terraces to the integrated outdoor lounge area this villa offers a protected and serene haven. Every corner of this residence invites you to relax and enjoy the harmonious connection with nature.

The villa includes: 5 bedrooms, 5 en-suite bathrooms, 2 guest toilets, extensive terraces, an integrated outdoor lounge area and a stunning swimming pool. Villa radiates sophisticated charm with its use of noble materials and top-tier specifications. It achieves an ideal synergy between state-of-the-art design and ecological sensitivity, featuring a minimal environmental footprint, green roofs, optional solar energy, and landscaping designed to thrive in drought conditions.

For those who crave a refined lifestyle in a tranquil and scenic environment, villa presents a unique chance to experience luxurious living seamlessly integrated with nature.

A natural setting with magnificent views and an ideal location for this Villa close enough to the towns, beaches and amenities along the coast - secluded enough to offer a peaceful haven.

- | | | |
|--|--|--|
|  5 sovrum |  5 badrum |  605m ² Bygg storlek |
|  2.210m ² Tomtstorlek | <input checked="" type="checkbox"/> Garden | <input checked="" type="checkbox"/> Private pool |
| <input checked="" type="checkbox"/> Gated | <input checked="" type="checkbox"/> Views: Sea | <input checked="" type="checkbox"/> Near Schools |
| <input checked="" type="checkbox"/> Near Commercial Center | <input checked="" type="checkbox"/> Air Conditioning: Pre-Installed | <input checked="" type="checkbox"/> Elevator/Lift |
| <input checked="" type="checkbox"/> Location: Coastal | <input checked="" type="checkbox"/> Number of Parking Spaces: 2 | <input checked="" type="checkbox"/> Beach: 7000 Meters |
| <input checked="" type="checkbox"/> Double Garage | <input checked="" type="checkbox"/> Double Bedrooms: 5 | <input checked="" type="checkbox"/> WC: 2 |
| <input checked="" type="checkbox"/> Terrace: 522 Msq. | <input checked="" type="checkbox"/> Useable Build Space: 484 Msq. | |