

4 спальная комната вилла продается в Estepona, Málaga

1.350.000€

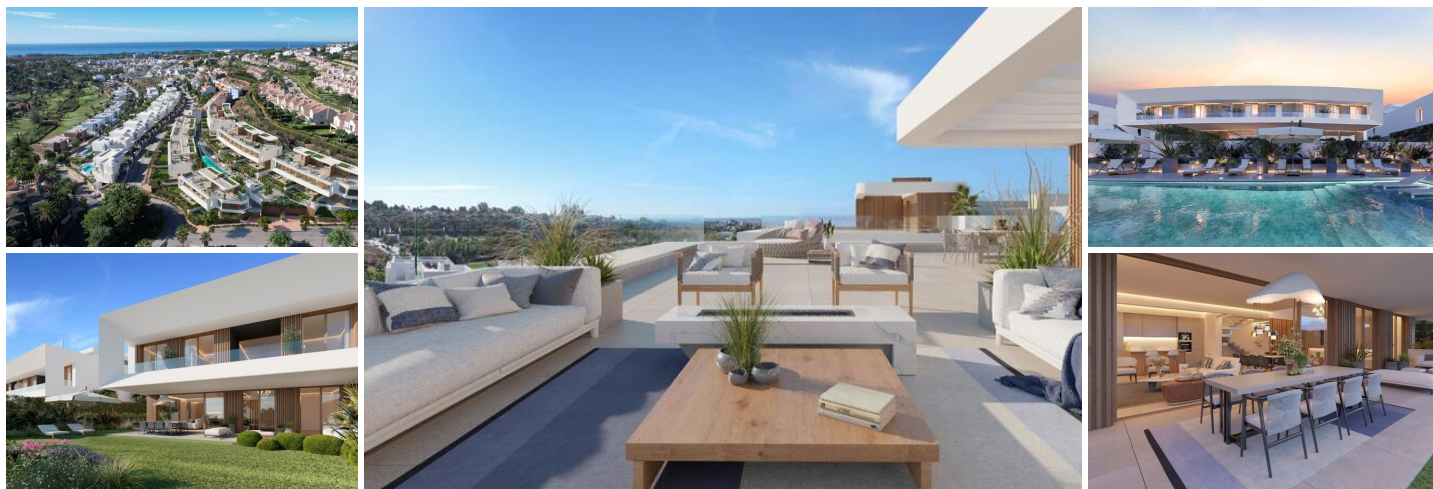

Introducing a boutique off-plan residential complex comprised of 15 modern homes nestled in the serene surroundings of El Campanario, enveloped by lush golf courses, prestigious private villas, and luxurious apartments. At the heart of the New Golden Mile, El Campanario boasts a charming golf course and clubhouse, serving as a delightful communal hub for residents.



Designed with a contemporary vision, this exclusive project offers spacious semi-detached homes with boutique-style amenities, including a fully equipped gym, spa, and outdoor swimming pool, all set against the backdrop of spectacular panoramic views. Optional extras such as a private rooftop pool can be added during the customisation phase.

Located just a short drive away from the vibrant hubs of Marbella and Puerto Banus, with their plethora of restaurants, shops, and services, the development provides easy access to urban conveniences while maintaining a sense of tranquility and relaxation in its open spaces.

Surrounded by renowned golf clubs such as El Paraíso, Atalaya, and Guadalmina, as well as shopping centers offering various services, the complex epitomizes the ideal balance between lifestyle and leisure.

Each home boasts underground parking for 2 cars, private gardens, large terraces, spacious solariums, and generous basements, providing the perfect setting for year-round entertainment with family and friends.

With seamlessly integrated indoor and outdoor spaces on the ground floor, these residences radiate with natural light, offering a sense of excitement and possibility for modern living. Experience the epitome of sophisticated living at

- | | | |
|--|--|--|
|  4 спальни |  4 ванные комнаты |  341 m ² Размер сборки |
| <input checked="" type="checkbox"/> Бассейн | <input checked="" type="checkbox"/> a estrenar | <input checked="" type="checkbox"/> aire acondicionado |
| <input checked="" type="checkbox"/> armarios empotrados | <input checked="" type="checkbox"/> azotea | <input checked="" type="checkbox"/> calefacción central |
| <input checked="" type="checkbox"/> cocina amueblada | <input checked="" type="checkbox"/> cocina equipada | <input checked="" type="checkbox"/> condominio |
| <input checked="" type="checkbox"/> edificio con garaje | <input checked="" type="checkbox"/> exterior | <input checked="" type="checkbox"/> gimnasio |
| <input checked="" type="checkbox"/> jardín | <input checked="" type="checkbox"/> jardín comunitario | <input checked="" type="checkbox"/> lavadero |
| <input checked="" type="checkbox"/> luminoso | <input checked="" type="checkbox"/> obra nueva | <input checked="" type="checkbox"/> parking |
| <input checked="" type="checkbox"/> piscina | <input checked="" type="checkbox"/> piscina comunitaria | <input checked="" type="checkbox"/> plaza garaje incluida |