

3 спальная комната квартира продается в Rincon de la Victoria, Málaga

393.000€

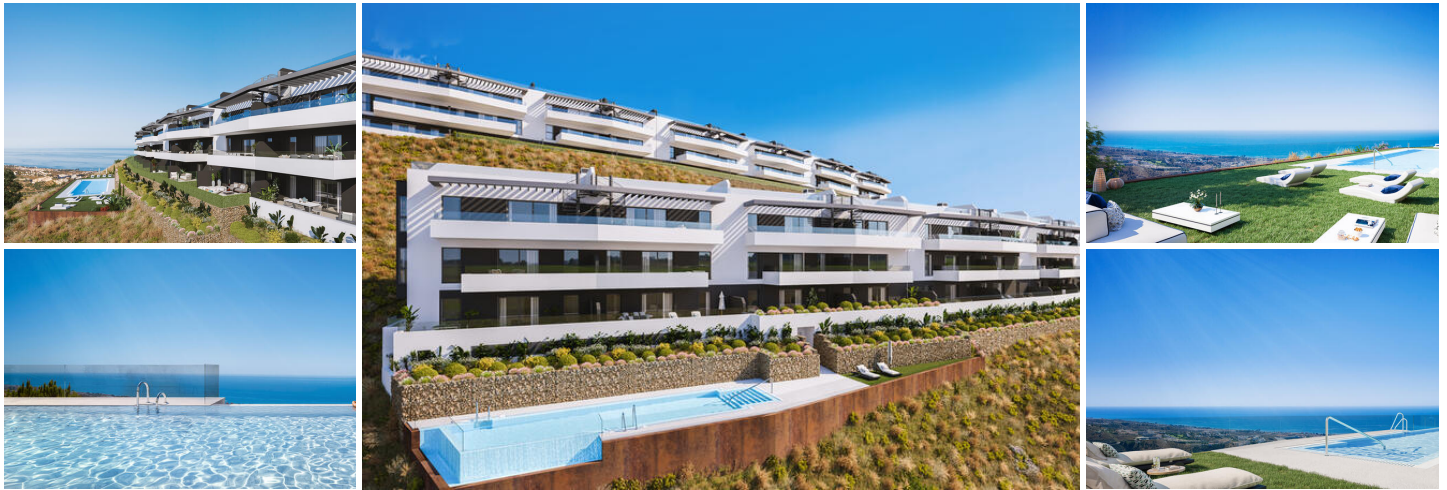





Welcome to this luxury stylish apartment complex in the beautiful natural surroundings of Rincón de la Victoria, Malaga in the Eastern Costa del Sol.

The first phase of these lifestyle-oriented two and three-bedroom apartments consists of 36 properties set within lush gardens and gorgeous greenery. A key feature is space, quality, amenities and fantastic sea and mountain views in a very natural and authentically Andalusian setting. This particular beauty spot is the ideal setting from which to explore the many delights of southern Spain.

The architecturally styled apartments stand out not only for the quality of their design, build and finishing, but also for the spacious, open-plan interiors and large, panoramic terraces, which form an extension of the interior living spaces. With their comfortable lounging and dining areas, they form the perfect spot in which to relax, entertain and spend quality time. The two and three bedroom apartments range between 90sqm and 100sqm, featuring spacious open plan living areas and modern kitchens with top range specs and appliances. It makes for a superb modern ambience with the highest levels of comfort and style that also includes private bedroom suites and bathrooms.

The kitchens will be furnished with a modern design and high and low modules with a laminated finish, including Silestone compact quartz worktops or similar. Option of choosing from the different colours. Balay household appliances or similar, with induction hob, extractor hood, oven, refrigerator, dishwasher and microwave. Sink with mixer taps and a high spout.

The hot water will be produced by means of solar panels located on the roof, supported by individual electric heaters

- | | | |
|---|--|--|
|  3 спальни |  2 ванные комнаты |  82m ² Размер сборки |
|  110m ² Размер участка | <input checked="" type="checkbox"/> Бассейн | <input checked="" type="checkbox"/> Modern |
| <input checked="" type="checkbox"/> Near beach | <input checked="" type="checkbox"/> Near town | <input checked="" type="checkbox"/> Near city |
| <input checked="" type="checkbox"/> Near airport | <input checked="" type="checkbox"/> Near golf | <input checked="" type="checkbox"/> Near schools |
| <input checked="" type="checkbox"/> Near hospital | <input checked="" type="checkbox"/> Sea views | <input checked="" type="checkbox"/> City views |
| <input checked="" type="checkbox"/> Air conditioning | <input checked="" type="checkbox"/> Superfast Fiber Internet | <input checked="" type="checkbox"/> Off road parking |
| <input checked="" type="checkbox"/> Lift | <input checked="" type="checkbox"/> Disabled Access | <input checked="" type="checkbox"/> Level plot |
| <input checked="" type="checkbox"/> One-floor | <input checked="" type="checkbox"/> Gymnasium | |