

4 спальная комната вилла продается в Estepona, Málaga

2.200.000€

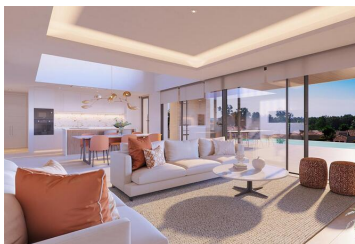





Discover a new development of seven luxury, south-facing detached villas located in the prime area of Atalaya-El Campanario in Estepona, Costa del Sol. Just a short drive from all amenities, the beach, and the vibrant Puerto Banús, these villas offer the perfect blend of luxury and convenience.

Each villa boasts large private pools and lush gardens, creating a serene and private oasis for residents. Choose between 3 or 4 en-suite bedrooms, with the added benefit of a full basement and a garage that accommodates two cars. The rooftop terraces provide stunning sea views, perfect for relaxing or entertaining guests.

The villas feature extensive terraces and double-height living room ceilings, adding to the sense of space and luxury. Built with top brands and high-quality materials, they include underfloor heating throughout and aérothermal heating technology for optimal comfort.

What sets these villas apart is the option for full cost-free interior customization and design services, allowing residents to create their dream home with flexible interior architecture. Additionally, a comprehensive after-sales service ensures a seamless and enjoyable living experience.

Backed by one of the leading and longest-established European developers, this development guarantees quality and reliability. The expected completion date is March 2026, offering an exciting opportunity to secure a luxury villa in one of the most sought-after locations on the Costa del Sol.

- | | | |
|---|--|---|
|  4 спальни |  4 ванные комнаты |  658m ² Размер сборки |
|  745m ² Размер участка | <input checked="" type="checkbox"/> Бассейн | <input checked="" type="checkbox"/> a estrenar |
| <input checked="" type="checkbox"/> aire acondicionado | <input checked="" type="checkbox"/> armarios empotrados | <input checked="" type="checkbox"/> azotea |
| <input checked="" type="checkbox"/> calefacción central | <input checked="" type="checkbox"/> cocina americana | <input checked="" type="checkbox"/> cocina amueblada |
| <input checked="" type="checkbox"/> cocina equipada | <input checked="" type="checkbox"/> edificio con garaje | <input checked="" type="checkbox"/> exterior |
| <input checked="" type="checkbox"/> jardín | <input checked="" type="checkbox"/> luminoso | <input checked="" type="checkbox"/> obra nueva |
| <input checked="" type="checkbox"/> parking | <input checked="" type="checkbox"/> piscina | <input checked="" type="checkbox"/> plaza garaje incluida |
| <input checked="" type="checkbox"/> solárium | <input checked="" type="checkbox"/> suelo radiante | <input checked="" type="checkbox"/> sótano |