

3 спальная комната квартира продается в Sotogrande, Cádiz

1.120.000€

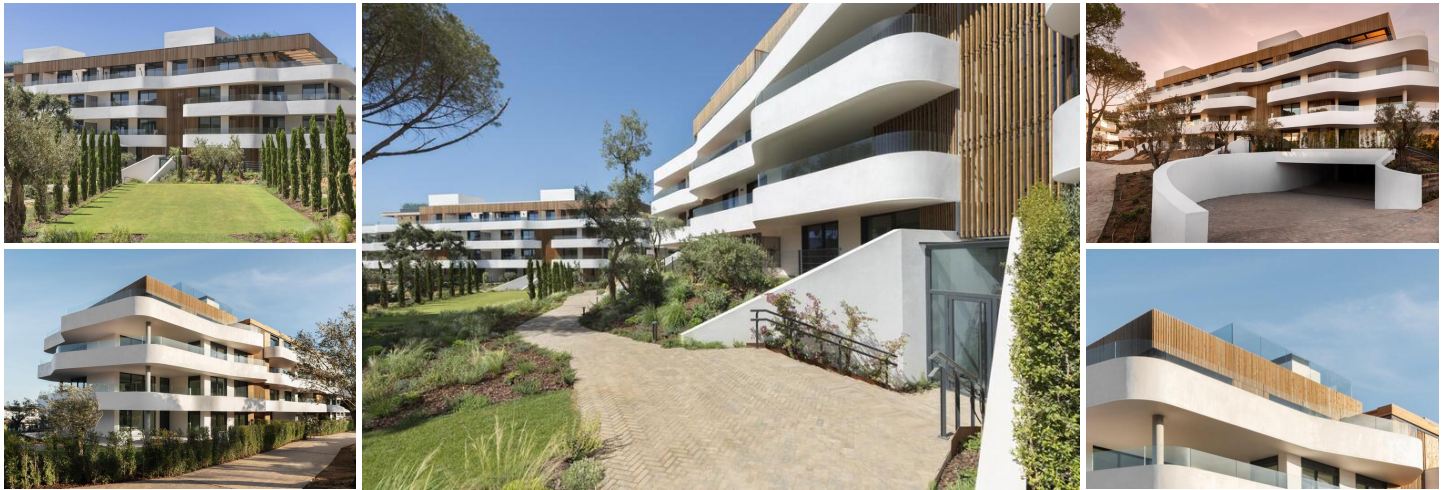





Welcome to our exclusive community of luxury apartments and Sky Villas in the heart of Sotogrande. Nestled among beautiful green spaces, Village Verde is located within La Reserva, just steps away from the club's state-of-the-art facilities. Village Verde offers a contemporary community lifestyle in this exclusive destination.

Designed with community, convenience, and luxury in mind, while respecting the natural beauty of the surroundings, this development is one of a kind. 124 apartments spread over six hectares of parkland offer unique communal spaces and cutting-edge facilities.

With sizes ranging from 181 to 524 square meters, these spacious apartments and Sky Villas feature sleek modern interiors opening onto beautiful terraces perfect for outdoor dining and relaxation. Each property benefits from terraces of at least 65 square meters, with large roof terraces for the Sky Villas and private gardens for ground floor apartments. All properties come with two private parking spaces and spacious storerooms.

With Sotogrande's exceptional leisure and sports activities, Village Verde offers an unmatched quality of life, with discretion and privacy assured.

- | | | |
|--|---|--|
|  Посмотреть видео тур |  3 спальни |  3 ванные комнаты |
|  195m ² Размер сборки | <input checked="" type="checkbox"/> Бассейн | <input checked="" type="checkbox"/> aire acondicionado |
| <input checked="" type="checkbox"/> alto standing | <input checked="" type="checkbox"/> armarios empotrados | <input checked="" type="checkbox"/> ascensor |
| <input checked="" type="checkbox"/> balcón | <input checked="" type="checkbox"/> calefacción central | <input checked="" type="checkbox"/> cocina americana |
| <input checked="" type="checkbox"/> cocina amueblada | <input checked="" type="checkbox"/> cocina equipada | <input checked="" type="checkbox"/> condominio |
| <input checked="" type="checkbox"/> edificio con garaje | <input checked="" type="checkbox"/> exterior | <input checked="" type="checkbox"/> gimnasio |
| <input checked="" type="checkbox"/> jardín | <input checked="" type="checkbox"/> jardín comunitario | <input checked="" type="checkbox"/> lavadero |
| <input checked="" type="checkbox"/> luminoso | <input checked="" type="checkbox"/> no amueblado | <input checked="" type="checkbox"/> parking |