

3 спальная комната городская тюрма продается в Pilar de la Horadada, Alicante
259.900€

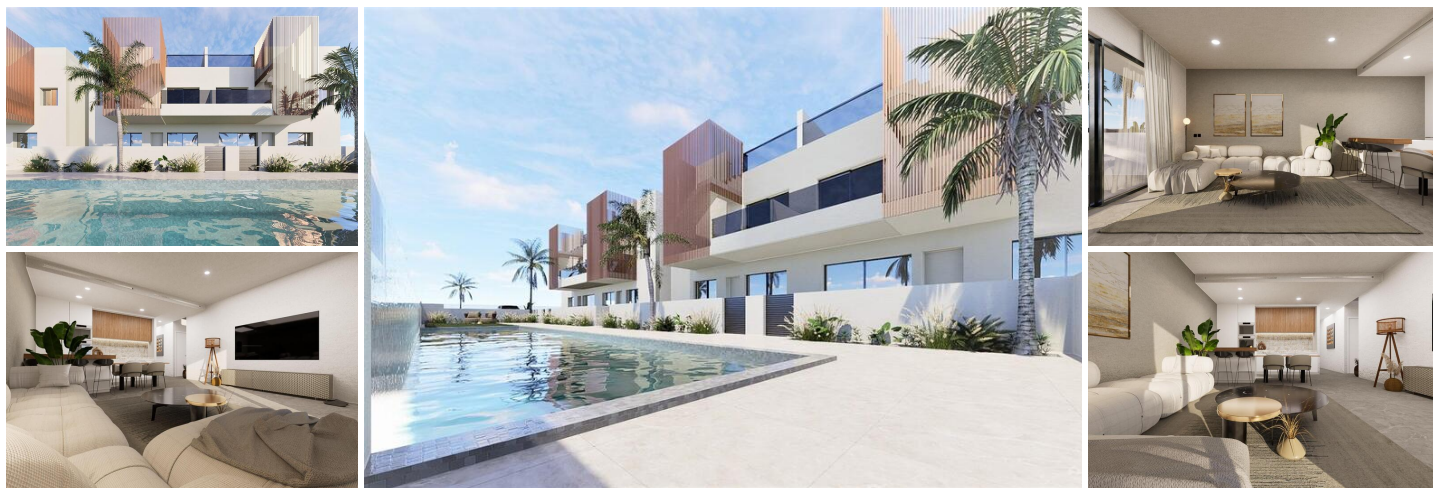

NEW BUILD BUNGALOWS IN PILAR DE LA HORADADA

New Build residential complex of bungalow apartments in Pilar de la Horadada.

The project will feature 8 bungalows within 2 blocks of 4 units on each one with 2 and 3 bedrooms and 2 fitted bathrooms.

All homes will have access to a community pool, and units on the higher floors will come with a solarium. Every aspect has been designed with practicality in mind, focusing on the present-day needs of residents.

Fully fitted kitchen with white goods, fitted bathrooms, lighting and building wardrobes with drawers. Solarium with Summer kitchen.

Residential located in Pilar de la Horadada, surrounded by all the services you need and just a few minutes from the beach.

Pilar de la Horadada is a typical Spanish village in the most southern part of the Costa Blanca.

The large main street has supermarkets, lots of shops, restaurants and bars and some lovely squares.

The beautiful beaches of Torre de la Horadada and Mil Palmeras with fine sand promenade is just 5 minutes away.

In Pilar de la Horadada there is also a well developed cycling and walking path network and there is also a large offer

- | | | |
|--|---|---|
| <input type="checkbox"/> 3 спальни | <input type="checkbox"/> 2 ванные комнаты | <input type="checkbox"/> 87m ² Размер сборки |
| <input type="checkbox"/> 50m ² Размер участка | <input checked="" type="checkbox"/> Garden | <input checked="" type="checkbox"/> Communal Pool |
| <input checked="" type="checkbox"/> Gated | <input checked="" type="checkbox"/> Number of Parking Spaces: 1 | <input checked="" type="checkbox"/> Near Schools |
| <input checked="" type="checkbox"/> Near Bus Route | <input checked="" type="checkbox"/> Location: Coastal, Urbanisation | <input checked="" type="checkbox"/> Air Conditioning: Pre-Installed |
| <input checked="" type="checkbox"/> Double Bedrooms: 3 | <input checked="" type="checkbox"/> Beach: 3500 Meters | <input checked="" type="checkbox"/> Key Ready |
| <input checked="" type="checkbox"/> Useable Build Space: 75 Msq. | <input checked="" type="checkbox"/> Terrace: 11 Msq. | |