

3 спальная комната квартира продается в Torrevieja, Alicante

585.000€

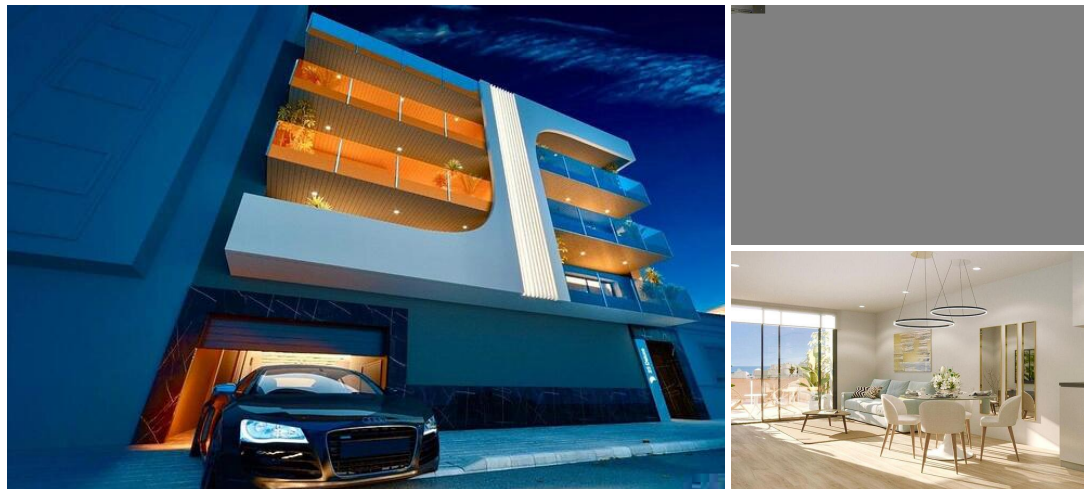

NEW BUILD PENTHOUSES IN TORREVIEJA NEAR THE BEACH

New Build development of 8 luxury apartments and penthouses in Torrevieja located just 150 meters from the beach.

Modern properties have 3 bedrooms, 3 bathrooms, open plan kitchen with the lounge area, heated bathrooms floors, spacious terraces, fully equipped wardrobes and kitchen.

Penthouses with private solariums.

Community pool and finish sauna, rooftop solarium with barbecue.

An options underground parking space at an extra cost.



Completion date end of 2025

Torrevieja is a Spanish town in the province of Alicante, on the Costa Blanca.

It is known for its typically Mediterranean climate and coastline. It has boardwalks with resorts along its sandy beaches.

The small Museum of the Sea and Salt houses exhibitions on the fishing and salt history of the city.

In the interior, the Lagunas de La Mata-Torrevieja Natural Park has trails and two salty lagoons, one pink and the other green.

- | | | |
|----------------------------------------------------------------------------------------------|------------------------------------------------------------------------------------------------------|-----------------------------------------------------------------------------------------------------------------------|
|  3 спальни |  3 ванные комнаты |  204m ² Размер сборки |
| <input checked="" type="checkbox"/> Бассейн | <input checked="" type="checkbox"/> Communal Pool | <input checked="" type="checkbox"/> Private Pool |
| <input checked="" type="checkbox"/> Parking | <input checked="" type="checkbox"/> Near bus route | <input checked="" type="checkbox"/> gated |
| <input checked="" type="checkbox"/> Near Schools | <input checked="" type="checkbox"/> Air Conditioning: Pre-Installed | <input checked="" type="checkbox"/> Double Bedrooms: 3 |
| <input checked="" type="checkbox"/> Near Commercial Center | <input checked="" type="checkbox"/> Location: Coastal | <input checked="" type="checkbox"/> Solarium: Yes |
| <input checked="" type="checkbox"/> Elevator/Lift | <input checked="" type="checkbox"/> Terrace: 93 Msq. | <input checked="" type="checkbox"/> Beach: 150 Meters |
| <input checked="" type="checkbox"/> Useable Build Space: 160 Msq. | <input checked="" type="checkbox"/> B | |