

## 2 спальная комната квартира продается в Benahavis, Málaga

849.000€

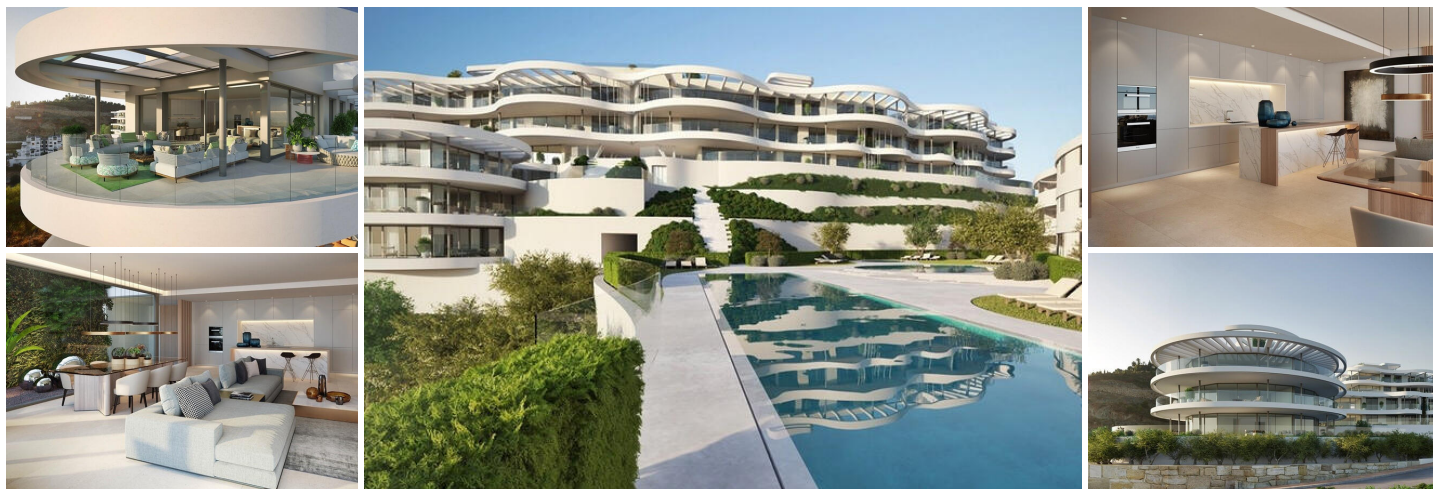



New development of luxury apartment that enjoys breath-taking views from its huge terraces across the Mediterranean Sea towards Gibraltar and the coasts of Africa.

From its elevated position just above Marbella's emblematic Golf Valley, the Golf courses of Los Naranjos, La Quinta, Las Brisas and Aloha are at your doorstep. At the gateway of natural reserves and Andalusian cultural heritage, these apartments invites you to enjoy life to the fullest.

You will experience luxurious and contemporary living in an exclusive location. The buildings are beautifully integrated within the natural surroundings and take full advantage of the amazing views. Starting with seven iconic buildings that will house 49 spacious residences set in beautiful gardens. The innovative concept will be followed in the second phase by a further 70 residences to complete the project. Every floor plan has been carefully studied to optimise the use of our generous internal spaces and natural light, to enjoy the stunning views, as well as to ensure the privacy of each home. The latest technologies will guarantee your full comfort and make you feel at home.

We offer apartment of 2, 3 and 4 bedroom. Let us guide you through the perfect home taking into account the needs of your family and ensuring your best comfort. The View Marbella pays special attention to durability and environmental protection. We work with construction methods, materials and fittings that strive to be sustainable, eco-friendly and optimise the efficiency of our homes. Relevant certificates such as BREEAM will be targeted. Will redefine and set new standards in the concept of real luxurious living with its contemporary architecture and state of the art interiors. Enjoy the panoramic views from your spacious terrace, observe the sunset, marvel at the beauty of the Mediterranean Sea and the surrounding mountains.

- |  |  |   |
|--|--|---|
|  2 спальни |  2 ванные комнаты |  126m <sup>2</sup> Размер сборки |
| <input checked="" type="checkbox"/> Бассейн  | <input checked="" type="checkbox"/> South orientation  | <input checked="" type="checkbox"/> 36 m <sup>2</sup> terrace   |
| <input checked="" type="checkbox"/> Garage   | <input checked="" type="checkbox"/> Communal garden  | <input checked="" type="checkbox"/> Communal pool   |
| <input checked="" type="checkbox"/> Air conditioning   | <input checked="" type="checkbox"/> Fully fitted kitchen   | <input checked="" type="checkbox"/> Utility room  |
| <input checked="" type="checkbox"/> Double glazing   | <input checked="" type="checkbox"/> Brand new  | <input checked="" type="checkbox"/> Telephone   |
| <input checked="" type="checkbox"/> Sea view   | <input checked="" type="checkbox"/> Mountain view  | <input checked="" type="checkbox"/> Internet - Wi-Fi  |
| <input checked="" type="checkbox"/> Covered terrace  | <input checked="" type="checkbox"/> Fitted wardrobes   | <input checked="" type="checkbox"/> Lift  |
| <input checked="" type="checkbox"/> Garden view  | <input checked="" type="checkbox"/> Pool view  | <input checked="" type="checkbox"/> Panoramic view  |