

3 bedroom Apartment for sale in Sotogrande, Cádiz

2,033,000€

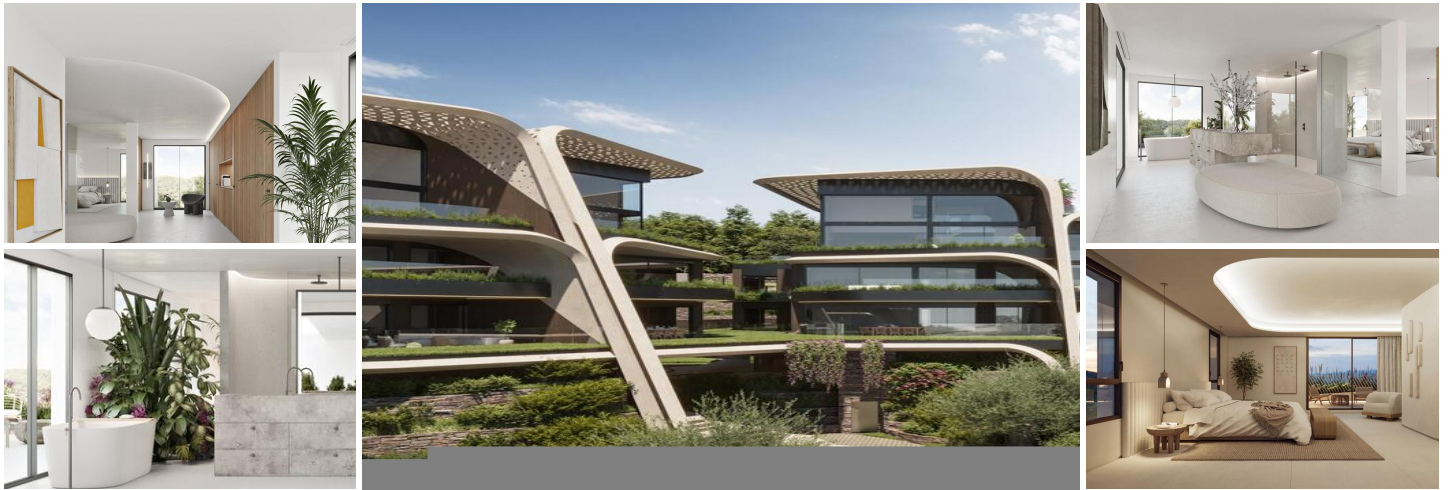





Stylish contemporary duplex penthouse with 3 bedrooms, 3 bathrooms, and a guest toilet. Located in a preserved, tranquil, and secure area, within a short walking distance from the International School of Sotogrande and a brief drive from Sotogrande's marina and golf courses.

Upon entering, you'll be greeted by a spacious living room connected to an open-plan dining area, seamlessly integrated with the fully equipped modern kitchen. There's also a guest toilet and a separate laundry room. Each room has its own private bathroom, with the spacious master suite featuring a generous walk-in closet and a luxurious bathroom.

This apartment offers the highest quality finishes, including an energy-efficient aerothermal pump for heating and air conditioning, climate and sound insulation, double-glazed windows, and high-quality porcelain flooring throughout the home. The complex also provides top-notch facilities, including a gastrobar, gym, heated indoor pool, and two outdoor pools, one exclusively for adults.

Situated in a complex that captures the breathtaking landscape, this apartment is part of the private and elegant Sotogrande, one of the most exclusive and sought-after residential areas in Europe. It's just a 7-minute walk from the International School of Sotogrande and less than a 10-minute drive from the exclusive La Reserva golf course and marina.

Feel free to get in touch with us for more information or to schedule a visit.

- | | | |
|---|--|---|
|  View Video Tour |  3 bedrooms |  3 bathrooms |
|  235m ² Build size | <input checked="" type="checkbox"/> Swimming Pool | <input checked="" type="checkbox"/> a estrenar |
| <input checked="" type="checkbox"/> aire acondicionado | <input checked="" type="checkbox"/> alto standing | <input checked="" type="checkbox"/> apartamento |
| <input checked="" type="checkbox"/> armarios empotrados | <input checked="" type="checkbox"/> ascensor | <input checked="" type="checkbox"/> bodega |
| <input checked="" type="checkbox"/> calefacción central | <input checked="" type="checkbox"/> cocina amueblada | <input checked="" type="checkbox"/> cocina equipada |
| <input checked="" type="checkbox"/> edificio con garaje | <input checked="" type="checkbox"/> exterior | <input checked="" type="checkbox"/> gimnasio |
| <input checked="" type="checkbox"/> jardín comunitario | <input checked="" type="checkbox"/> lavadero | <input checked="" type="checkbox"/> luminoso |
| <input checked="" type="checkbox"/> obra nueva | <input checked="" type="checkbox"/> parking | <input checked="" type="checkbox"/> patio de luces |