

2 bedroom Townhouse for sale in Orihuela Costa, Alicante

342,000€

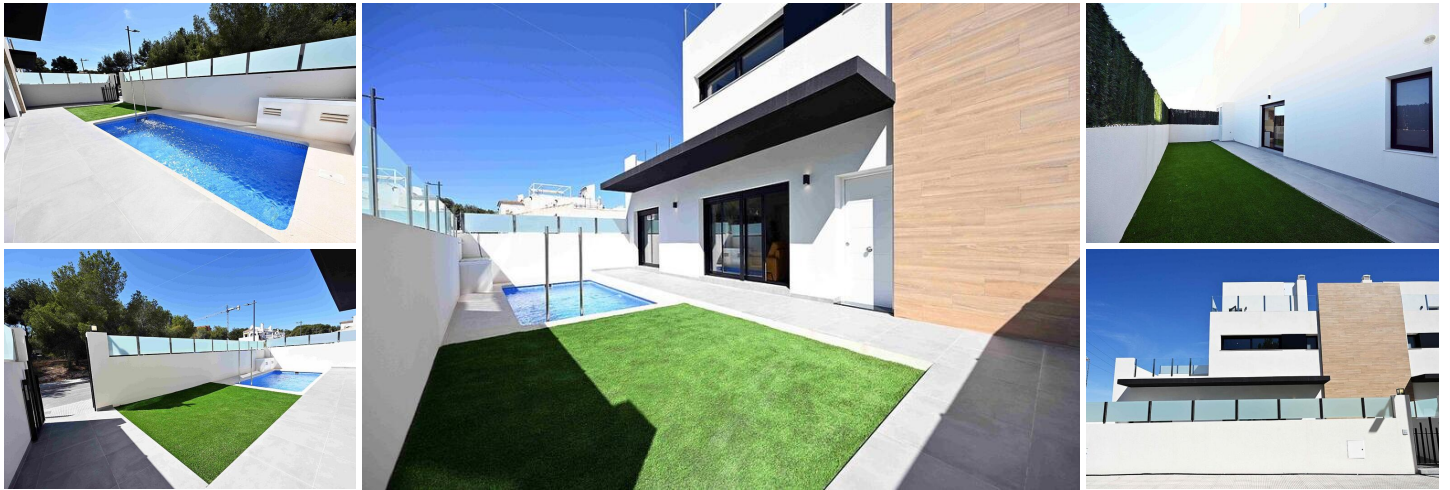

NEW BUILD TOWNHOUSES IN ORIHUELA COSTA

New Build townhouses in Las Filipinas, Orihuela Costa.

The complex of 12 townhouses, each with 2 bedrooms, 2 bathrooms, front and back yards and their own roof terrace.

On the ground floor there is a bright living room with an open-plan kitchen, a spacious bedroom with built-in wardrobe and a bathroom.





On the first floor there is a second large bedroom with built-in wardrobe and a bathroom. From the bedroom there is an exit to a sunny balcony with space for terrace furniture.

Upstairs you have the roof terrace where you can place an outdoor kitchen, jacuzzi and chill-out area.

The properties come with pre-installed ducted A/C, fitted bathrooms, aerothermic hot water system, intercom, LED lighting package, outdoor kitchen and parking space.

Private swimming pool 5.5 x 2.5 m .

Development located near three popular golf courses (Villamartin, Las Ramblas and Campoamor), just five minutes from the best beaches of Orihuela Costa.

- | | | |
|--|---|---|
|  2 bedrooms |  2 bathrooms |  97m ² Build size |
|  178m ² Plot size | <input checked="" type="checkbox"/> Swimming Pool | <input checked="" type="checkbox"/> Private Pool |
| <input checked="" type="checkbox"/> Garden | <input checked="" type="checkbox"/> gated | <input checked="" type="checkbox"/> Number of Parking Spaces: 1 |
| <input checked="" type="checkbox"/> Near Golf / Golf Resort Property | <input checked="" type="checkbox"/> Near Schools | <input checked="" type="checkbox"/> Air Conditioning: Pre-Installed |
| <input checked="" type="checkbox"/> Near Commercial Center | <input checked="" type="checkbox"/> Double Bedrooms: 2 | <input checked="" type="checkbox"/> Location: Coastal, Urbanisation |
| <input checked="" type="checkbox"/> Solarium: Yes | <input checked="" type="checkbox"/> Useable Build Space: 80 Msq. | <input checked="" type="checkbox"/> Terrace: 73 Msq. |
| <input checked="" type="checkbox"/> Beach: 5000 Meters | <input checked="" type="checkbox"/> B | |