

## 2 bedroom Apartment for sale in Finestrat, Alicante

269,000€

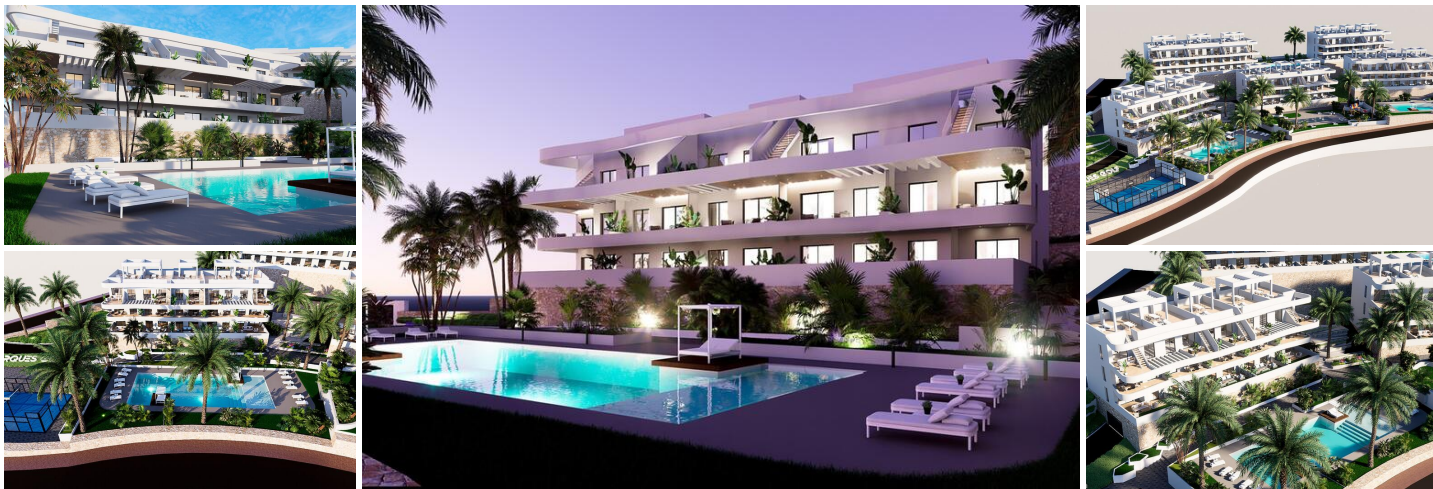



Introducing a new project in Finestrat featuring luxurious 2-bedroom, 2-bathroom apartments across three floors. The ground floor units boast private gardens, middle floor units offer spacious terraces, and top floor units include a stunning solarium.

The development offers extensive amenities, including three swimming pool areas, a padel court, a fitness area, a playground, electric car charging stations, a monitored security area, parking, and a dedicated jacuzzi area.

Enjoy the perfect blend of comfort, convenience, and recreation in this exceptional new community.

Finestrat is a beautiful coastal town with a mountainous landscape. It combines the cosmopolitan atmosphere of the family-friendly "La Cala" beach with the tranquillity of the 1410-metre-high "Puig Campana". Nearby is the theme park Terra Mitica, Aqualandia water park, and the Mundomar marine park. For golf lovers, there are two golf courses: Real Faula and Sierra Cortina. Finestrat is the ideal place for a golfing holiday.

Contact us for more information.

- |   |   |   |
|---|---|---|
|  2 bedrooms |  2 bathrooms |  68m <sup>2</sup> Build size |
| <input checked="" type="checkbox"/> Swimming Pool   | <input checked="" type="checkbox"/> Pool  | <input checked="" type="checkbox"/> Children's pool   |
| <input checked="" type="checkbox"/> Communal pool   | <input checked="" type="checkbox"/> Parking   | <input checked="" type="checkbox"/> Underground parking   |
| <input checked="" type="checkbox"/> Close to sea  | <input checked="" type="checkbox"/> Close to shops  | <input checked="" type="checkbox"/> Close to supermarkets   |
| <input checked="" type="checkbox"/> Close to restaurants                                      | <input checked="" type="checkbox"/> Fitted wardrobes  | <input checked="" type="checkbox"/> Fitted kitchen  |
| <input checked="" type="checkbox"/> Pre-installed air conditioning                            | <input checked="" type="checkbox"/> Communal garden   | <input checked="" type="checkbox"/> Private garden  |
| <input checked="" type="checkbox"/> Private terrace   | <input checked="" type="checkbox"/> Gated complex   | <input checked="" type="checkbox"/> Reinforced door   |
| <input checked="" type="checkbox"/> Garden & pool views                                       | <input checked="" type="checkbox"/> Panoramic views   | <input checked="" type="checkbox"/> Gym   |