

2 Cuartuo Ar ppe nrv v m CGra C pd l Gt S Go Gt Sr ngr el tG, i r r G l v
 9. 5055€

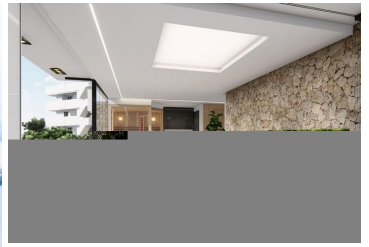

NEW BUILD RESIDENTIAL IN EL RASO, GUARDAMAR DEL SEGURA

New Build private residential complex of apartments in El Raso, Guardamar del Segura.

Complex consisting of 135 homes with 2 or 3 bedrooms in blocks of 3 or 5 floors plus solarium, designed in a minimalist way and with high quality standards, its modern architecture harmonises with our large open spaces, nature and swimming pools, offering a unique and peaceful atmosphere.

Beautiful residential complexes, including a glassed-in GYM-Spa area with views of green areas, swimming pools and from its terrace overlooking the salt lagoon of La Mata, paddle tennis court, etc.



Furniture pack included in the price.

Parking space included in the price.

Development is located on a unique and unrepeatable plot, bordering the natural landscape of the salt lagoon, enjoy its biodiversity and unique environment, in El Raso de Guardamar del Segura, with all kinds of services and amenities and close to the best beaches of the Mediterranean.

At the same time, thanks to the proximity of El Moncayo beach, you will be able to go for a bike ride and enjoy the best climate of the Costa Blanca.

Additionally, and thanks to the five levels of some of the blocks that make up the residential, all of them facing south

- | | | |
|--|---|--|
|  3 soverom |  2 bad |  117m ² Bygg størrelse |
| <input checked="" type="checkbox"/> Svømmebasseng | <input checked="" type="checkbox"/> Communal Pool | <input checked="" type="checkbox"/> Furnished |
| <input checked="" type="checkbox"/> Jacuzzi | <input checked="" type="checkbox"/> Gym | <input checked="" type="checkbox"/> Gated |
| <input checked="" type="checkbox"/> Solarium: Yes | <input checked="" type="checkbox"/> Number of Parking Spaces: 1 | <input checked="" type="checkbox"/> Air Conditioning: Pre-Installed |
| <input checked="" type="checkbox"/> Double Bedrooms: 3 | <input checked="" type="checkbox"/> Near Schools | <input checked="" type="checkbox"/> Near Commercial Center |
| <input checked="" type="checkbox"/> Useable Build Space: 100 Msq. | <input checked="" type="checkbox"/> Elevator/Lift | <input checked="" type="checkbox"/> Beach: 3000 Meters |
| <input checked="" type="checkbox"/> Location: Urbanisation | <input checked="" type="checkbox"/> Terrace: 217 Msq. | |