

## 2 soverom Leilighet til salgs i Torrevieja, Alicante

285.000€

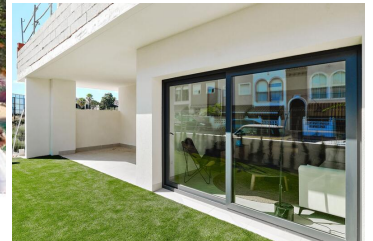



New apartment complex only 200m from the beach in La Veleta, a quiet residential area between the municipalities of Torrevieja and Orihuela Costa. Within walking distance of the complex is a wide variety of daily amenities, like supermarkets, post office, banks, shops, bars and restaurants.

Apartment complex, comprises apartment blocks in two levels, offering apartments with 2 or 3 bedrooms and 2 bathrooms, in a choice of models: ground floor with a large garden; or top floor with private solarium. Both models present an open-plan lounge, dining and kitchen area, opening onto a terrace. For an additional price it is possible to build a pool in the garden of the ground floor apartments, or install a jacuzzi on the solarium of the top floor apartments.

The community areas offer a Mediterranean feel, with gardens surrounding a large pool for adults and children. To promote 'sustainable living' the garden areas will be planted with local plants and palm trees, reducing the water consumption. There is also outdoor fitness equipment available to residents, and an underground parking garage. The apartments have a minimalist design and include ducted A/C, underfloor heating in the bathrooms, fitted wardrobes, electric blinds, and a parking space.

Interested? Do not hesitate and contact us. We are happy to help you further.

- |  |   |  |
|--|---|--|
|  2 soverom |  2 bad |  102m <sup>2</sup> Bygg størrelse |
| <input checked="" type="checkbox"/> Svømmebasseng  | <input checked="" type="checkbox"/> Pool  | <input checked="" type="checkbox"/> Communal pool  |
| <input checked="" type="checkbox"/> Heated pool  | <input checked="" type="checkbox"/> Pool optional   | <input checked="" type="checkbox"/> Parking  |
| <input checked="" type="checkbox"/> Private parking  | <input checked="" type="checkbox"/> Underground parking                                   | <input checked="" type="checkbox"/> Lift   |
| <input checked="" type="checkbox"/> Close to shops   | <input checked="" type="checkbox"/> Close to supermarkets                                 | <input checked="" type="checkbox"/> Close to restaurants   |
| <input checked="" type="checkbox"/> Fitted wardrobes   | <input checked="" type="checkbox"/> Fitted bathroom                                       | <input checked="" type="checkbox"/> Air conditioning   |
| <input checked="" type="checkbox"/> Communal garden  | <input checked="" type="checkbox"/> Gated complex   | <input checked="" type="checkbox"/> Video entry system   |
| <input checked="" type="checkbox"/> Electric blinds  | <input checked="" type="checkbox"/> Unfurnished   | <input checked="" type="checkbox"/> Garden & pool views  |