

## 2 soverom Leilighet til salgs i La Gaspara, Málaga

455.000€

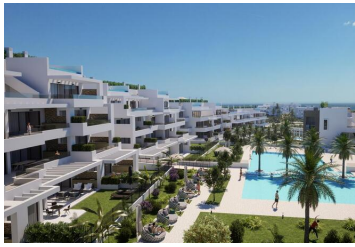



Welcome to this brand new development, where quality and comfort come together. This iconic development offers 67 modern apartments in the authentic and beautiful Estepona, one of the most desired places on the Costa del Sol. Most of the apartments enjoy stunning sea views, while the penthouses boast a terrace with a private pool.

This ground floor apartment has 2 bedrooms, 2 bathrooms and a private garden.

Conveniently located within walking distance to the beach, amenities, and exclusive golf courses, this is the epitome of the Mediterranean lifestyle, combined with a touch of Northern European design. The apartments feature a well-thought-out floor plan, spacious showers in the bathrooms (without bidet or bath), and generous terraces perfect for outdoor enjoyment.

Situated in the up-and-coming area of Arroyo Enmedio, southwest Estepona, the development offers breathtaking sea views on the south side and spectacular mountain views on the north side. Supermarkets, restaurants, shops, and the beach are all within easy reach, making this a truly desirable and convenient location to call home.

- |  |   |   |
|--|---|---|
|  2 soverom |  2 bad |  99m <sup>2</sup> Bygg størrelse |
| <input checked="" type="checkbox"/> Svømmebasseng  | <input checked="" type="checkbox"/> a estrenar  | <input checked="" type="checkbox"/> aire acondicionado  |
| <input checked="" type="checkbox"/> apartamento  | <input checked="" type="checkbox"/> armarios empotrados                                   | <input checked="" type="checkbox"/> ascensor  |
| <input checked="" type="checkbox"/> calefacción central                                      | <input checked="" type="checkbox"/> cocina amueblada                                      | <input checked="" type="checkbox"/> cocina equipada   |
| <input checked="" type="checkbox"/> céntrico   | <input checked="" type="checkbox"/> edificio con garaje                                   | <input checked="" type="checkbox"/> exterior  |
| <input checked="" type="checkbox"/> jardín   | <input checked="" type="checkbox"/> jardín comunitario                                    | <input checked="" type="checkbox"/> luminoso  |
| <input checked="" type="checkbox"/> obra nueva   | <input checked="" type="checkbox"/> parking   | <input checked="" type="checkbox"/> piscina comunitaria   |
| <input checked="" type="checkbox"/> plaza garaje incluida                                    | <input checked="" type="checkbox"/> terraza   | <input checked="" type="checkbox"/> urbanizacion privada  |