

## 2 soverom Leilighet til salgs i Manilva, Málaga

366.949€

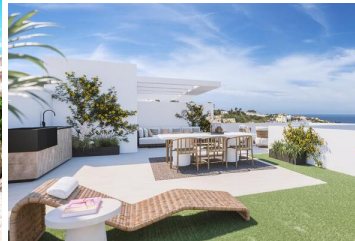

Welcome to an exclusive new development nestled in the tranquil coastal town of Manilva, where breathtaking panoramic views stretch across the Mediterranean Sea, Gibraltar, and even the distant shores of Africa. This exceptional project is designed to offer the ultimate Costa del Sol lifestyle.



The development is off plan and will start construction in Q1 2025 and will be ready for the start of 2027. With favourable payment terms in place, it's an ideal investment.

The complex is a private, gated community featuring three elegantly designed buildings, each offering a unique selection of residences. Choose from luxurious duplex penthouses with expansive terraces, charming ground-floor apartments with private gardens, or stylish first-floor apartments—all thoughtfully crafted to meet your every need. The community also features a gym and clubhouse for residents.

With just 45 residences available, the community ensures a sense of exclusivity and serenity, perfect for those seeking a peaceful retreat. Enjoy sun-soaked days and the laid-back lifestyle that the Costa del Sol is famous for, all within a setting that harmoniously blends natural beauty with modern convenience.

Each unit is sold with a parking space and a storage unit included in the price.

Ideally situated close to Sotogrande, the project provides easy access to a wide array of services, leisure activities, and sports facilities, ensuring that you can fully embrace the vibrant and diverse offerings of this stunning region. Whether you're looking for a permanent residence, a holiday getaway, or an investment opportunity, this community promises a life of comfort, luxury, and unparalleled views.

- |  |   |  |
|--|---|--|
|  2 soverom |  2 bad |  122m <sup>2</sup> Bygg størrelse |
| <input checked="" type="checkbox"/> Svømmebasseng  | <input checked="" type="checkbox"/> a estrenar  | <input checked="" type="checkbox"/> aire acondicionado   |
| <input checked="" type="checkbox"/> apartamento  | <input checked="" type="checkbox"/> armarios empotrados                                   | <input checked="" type="checkbox"/> ascensor   |
| <input checked="" type="checkbox"/> balcón   | <input checked="" type="checkbox"/> bodega  | <input checked="" type="checkbox"/> calefacción central  |
| <input checked="" type="checkbox"/> cocina americana   | <input checked="" type="checkbox"/> cocina amueblada                                      | <input checked="" type="checkbox"/> cocina equipada  |
| <input checked="" type="checkbox"/> edificio con garaje                                      | <input checked="" type="checkbox"/> exterior  | <input checked="" type="checkbox"/> gimnasio   |
| <input checked="" type="checkbox"/> jardín comunitario                                       | <input checked="" type="checkbox"/> luminoso  | <input checked="" type="checkbox"/> obra nueva   |
| <input checked="" type="checkbox"/> parking  | <input checked="" type="checkbox"/> piscina   | <input checked="" type="checkbox"/> piscina comunitaria  |