

2 soverom Leilighet til salgs i Finestrat, Alicante

289.900€

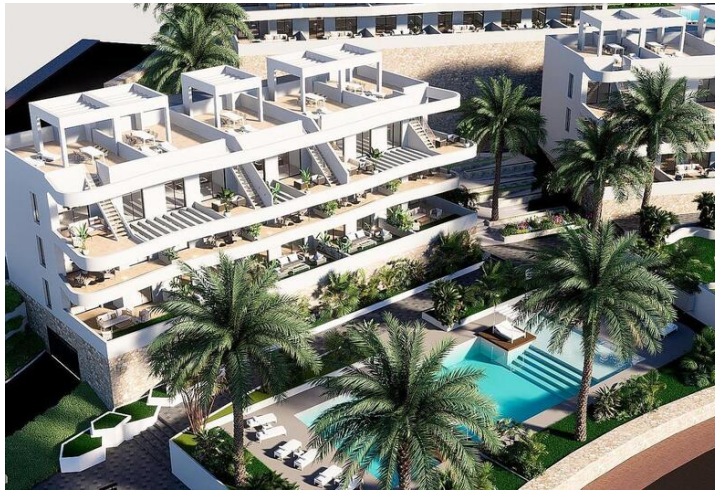
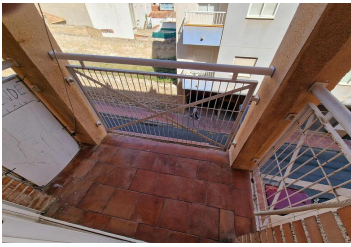

NEW BUILD RESIDENTIAL COMPLEX IN FINESTRAT

New Build residential complex in Balcon de Finestrat.

This complex of modern apartments with 2 bedrooms, 2 bathrooms, open plan kitchen with the living area. Some of the apartments will have sea views.

Ground floor apartment with a private gardens, middle floor apartments with the terraces and top floor apartments has a terraces and private solariums.



Each property has private underground parking space.

The properties have access to the communal area with 3 swimming pools, parking, paddle, playground, calisthenics. It is a great opportunity and privilege to be able to live with this environment of golf and beach, close to all amenities of all services considered one of the best places to invest.

Finestrat located in the Marina Baja region of the Costa Blanca.

Benidorm is just a five-minute drive from the properties and offers all the services you would need including shops, bars, restaurants, supermarkets, banks, pharmacies and several private international schools.

Close to the beaches of Levante, Poniente and Cala de Finestrat, with more than 6km in length that are among the best in Europe awarded by the European Union with Blue Flag.

- | | | |
|--|---|---|
|  2 soverom |  2 bad |  68m ² Bygg størrelse |
| <input checked="" type="checkbox"/> Svømmebasseng | <input checked="" type="checkbox"/> Communal Pool | <input checked="" type="checkbox"/> gated |
| <input checked="" type="checkbox"/> Number of Parking Spaces: 1 | <input checked="" type="checkbox"/> Near Golf / Golf Resort Property | <input checked="" type="checkbox"/> Near Schools |
| <input checked="" type="checkbox"/> Air Conditioning: Pre-Installed | <input checked="" type="checkbox"/> Near Commercial Center | <input checked="" type="checkbox"/> Useable Build Space: 60 Msq. |
| <input checked="" type="checkbox"/> Double Bedrooms: 2 | <input checked="" type="checkbox"/> Near Childrens Parks | <input checked="" type="checkbox"/> Elevator/Lift |
| <input checked="" type="checkbox"/> Location: Coastal, Mountain, Urbanisation | <input checked="" type="checkbox"/> Near Train Station | <input checked="" type="checkbox"/> Beach: 5000 Meters |
| | <input checked="" type="checkbox"/> Terrace: 31 Msq. | <input checked="" type="checkbox"/> B |