

2 soverom Villa til salgs i Pego, Alicante

348.000€

1º PRESUPUESTO (INICIAL)

- Parcela en "verdales" según planos adjuntos.
- Construcción llaves en mano según planos adjuntos.
- Memoria de calidades anexa.
- Vallado de parcela con puerta peatonal y puerta acceso vehículos
- Instalación de aire acondicionado.
- Pergola exterior.

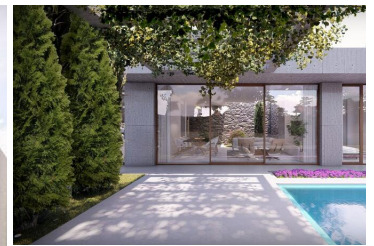

The new building project Verdales comprises ten semi-detached houses with an attractive contemporary design on private plots in Pego, La Marina Alta, 9 km from the beaches and 12 km from Denia, the capital.

Villa Verdales is a single storey building. As you enter, you will find spacious open-plan common areas with a large kitchen and living-dining room with an inner garden. Large windows that open completely allow the interior and exterior areas to merge, letting in a pleasant breeze in summer and the aroma of orange blossoms in spring.

Both bedrooms are separated from the common areas, with the master bedroom having an en-suite bathroom and a dressing room.

The price of 240.000 euros includes the fenced plot with a fence and a pedestrian door, turnkey construction of the house, carport (without concrete area) and garden.

The swimming pool at a price of 12.000 euros is optional. Taxes and notary and registration fees are not included.

Start of construction: February 2020

Completion: Spring 2021

Pego is a lively town of about 11.000 inhabitants with excellent communication routes. Between the city and the beaches is another jewel of La Marina Alta, the Marjal Natural Park and its great biodiversity and rivers with crystal clear water. Next to it are the fields of the famous Bomba rice. Pego is situated at the foot of the mountains, a paradise for walking or cycling.

Details of the building specifications

Exterior carpentry: PVC with swinging, folding or sliding opening, with high energy performance, resistance and high watertightness, with quality seal and very low thermal transmittance in soft, white or grey colour.

Guardian Sun type double glazing, with two colourless panes and an insulating and hygroscopic intermediate air chamber, with interior inert gas. Glazing located below 100 cm will be with laminated safety glass.

🏠 2 soverom

🛀 2 bad

🏠 118m² Bygg størrelse

📏 330m² Tomtestørrelse

✅ Svømmebasseng