

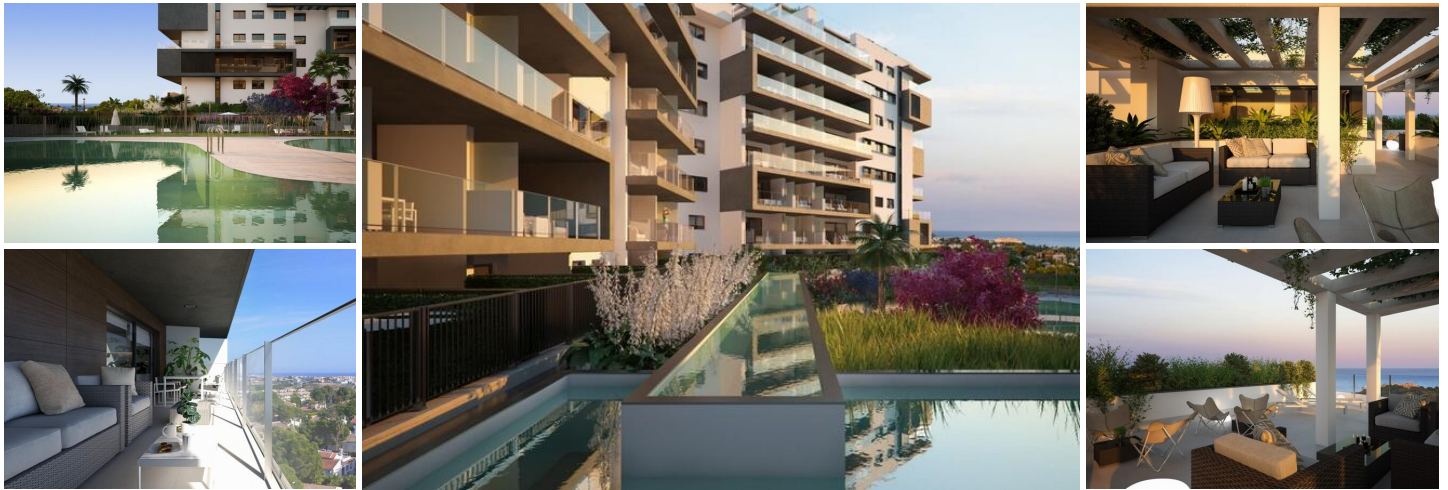

## 3 slaapkamer Appartement Te koop in Orihuela Costa, Alicante

351.600€



NEW LUXURY RESIDENTIAL APARTMENTS IN CAMPOAMOR close to the beach.

This 97m2 apartment consists of 3 bedrooms, 2 bathrooms with a large 15m2 private terrace, and a kitchen equipped with modern appliances.

The Residencial is located in the highest part of Campoamor, very close to La Glea beach and the marina. Residents will enjoy spacious terraces, ocean and nature views, and beautiful ornamental gardens. Its imposing façade, the balance of its forms, the garden inside it and the huge terraces of the houses make this residencial a beautiful architectural landmark in the Mediterranean. A home where you can live the life you have always dreamed of with the most beautiful horizon in the background: the Mediterranean.

A contemporary and modern architectural design that offers exclusive homes with top quality finishes, merging spaciousness and new technologies in terms of efficiency and construction. Living in this residencial is to feel the Mediterranean in each room of the house.

Imagine a place where the sea and nature become the protagonists of an incredible story: yours. Imagine an environment where you can unleash your imagination and live a thousand adventures by land sea.

The common areas have been designed for the whole family to enjoy . You can count on green areas to walk and sunbathe. In the common areas there is a large indoor heated pool, a chill out space on the roof, as well as the sports area to enjoy outdoor exercise, a gym, children's play area and a large outdoor pool next to a smaller one for children.

- |                               |                  |                              |
|-------------------------------|------------------|------------------------------|
| 3 slaapkamers                 | 2 badkamers      | 97m <sup>2</sup> Bouwgrootte |
| Panoramic views               | Gated complex    | Terrace                      |
| Communal pool                 | Gymnasium        | Landscaped gardens           |
| Parking                       | Near beach       | Close to airport             |
| Close to golf                 | Close to schools | Close to shops               |
| Coastal, Popular urbanisation | Roof terrace     | Lift                         |