

2 Cuarto Apartamento en venta en Benidorm, Alicante

690.000€

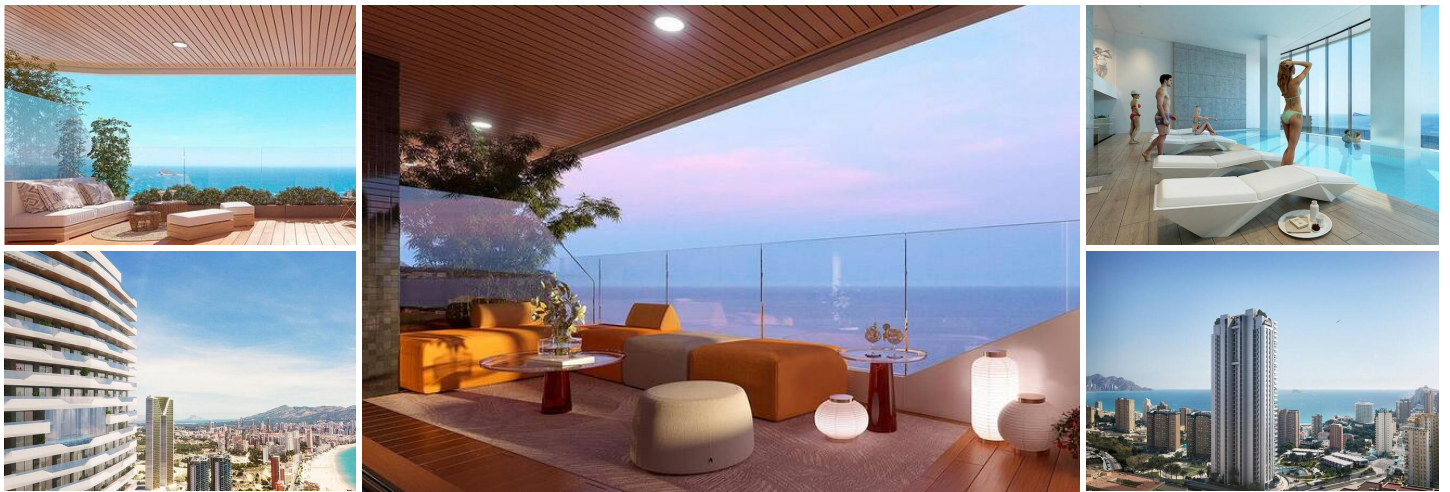

NEW CONSTRUCTION RESIDENTIAL IN PLAYA PONIENTE DE BENIDORM !!!

New residential sea views with 220 homes with 2, 3 and 4 bedrooms in a glass tower with spacious terraces with views.

Equipment :

Appliances: Hood, Oven and touch-control induction hob, Refrigerator, Dishwasher, Washing machine, Pre-installation for dryer and microwave.



Shower screen with safety glass, Mirror, Lighting with LED spotlights

Air conditioner

Aerothermy

The common areas are equipped with an adult pool, a children's pool, a spa, jacuzzis, a chill out area, a children's play area, two paddle courts, a garage, etc.

The Alicante coast is well known for its mild temperatures and its more than 300 days of sunshine a year. The city of Benidorm is known for its unbeatable hotel, sun and beach infrastructures, combined with a wide variety of traditional Spanish, Basque or Valencian cuisine as well as other international varieties adapted to all tastes and desire to experiment. It has different golf courses just 5 minutes away from Sierra Cortina, Golf Bahia, three theme parks and several shopping centers.

- | | | |
|--|---|---|
|  2 dormitorios |  2 baños |  80m ² Tamaño de construcción |
| <input checked="" type="checkbox"/> Piscina | <input checked="" type="checkbox"/> Communal Pool | <input checked="" type="checkbox"/> Games Room |
| <input checked="" type="checkbox"/> Gym | <input checked="" type="checkbox"/> Jacuzzi | <input checked="" type="checkbox"/> Views: Sea |
| <input checked="" type="checkbox"/> Key ready | <input checked="" type="checkbox"/> Near bus route | <input checked="" type="checkbox"/> gated |
| <input checked="" type="checkbox"/> Near Golf / Golf Resort Property | <input checked="" type="checkbox"/> Near Schools | <input checked="" type="checkbox"/> Near Trees |
| <input checked="" type="checkbox"/> Near Commercial Center | <input checked="" type="checkbox"/> Double Bedrooms: 2 | <input checked="" type="checkbox"/> Location: Coastal, Urbanisation |
| <input checked="" type="checkbox"/> Elevator/Lift | <input checked="" type="checkbox"/> Air Conditioning: Yes | <input checked="" type="checkbox"/> Terrace: 20 Msq. |
| <input checked="" type="checkbox"/> Useable Build Space: 68 Msq. | <input checked="" type="checkbox"/> Beach: 450 Meters | <input checked="" type="checkbox"/> Parking - Space |