

3 Cuarto Apartamento en venta en Benidorm, Alicante

1.025.000€

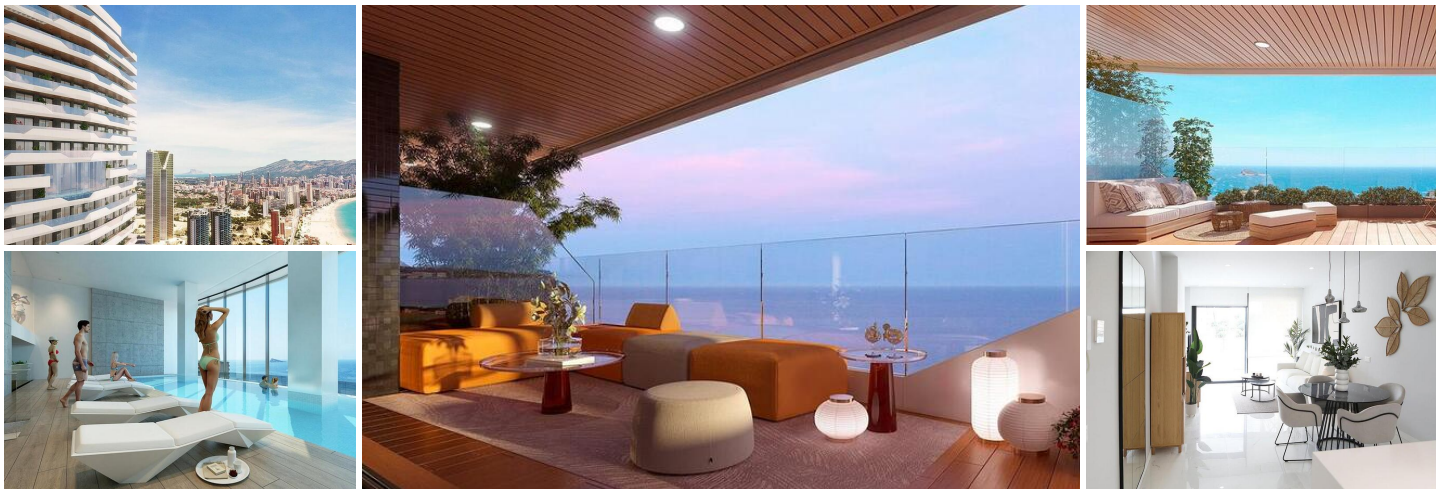

Located in Benidorm Next to Playa de Poniente.

New residential with sea views with 220 homes with 2, 3 and 4 bedrooms in a glass tower with spacious terraces with views.

Equipment :

Appliances: Hood, Oven and touch-control induction hob, Refrigerator, Dishwasher, Washing machine, Pre-installation for dryer and microwave.

Shower screen with safety glass, Mirror, Lighting with LED spotlights

Air-conditioning

Aerothermal

The common areas are equipped with a swimming pool for adults, a children's pool, spa, jacuzzis, chillout, children's play area, two paddle tennis courts. Heated pool and gym on the 26th floor with great views of the sea. Coworking area.

Each house has a parking space and a storage room included in the price.

The Alicante coast is well known for its mild temperatures and more than 300 sunny days a year. Known for its unrivaled hotel, sun and beach infrastructures, combined with a wide gastronomic variety, both traditional Spanish, Basque or Valencian, as well as other international varieties adapted to all tastes and the desire to experiment. It has different golf courses just 5 minutes away from Sierra Cortina, Golf Bahía, three theme parks and several shopping

- | | | |
|--|---|---|
| 3 dormitorios | 2 baños | 127m ² Tamaño de construcción |
| <input checked="" type="checkbox"/> Piscina | <input checked="" type="checkbox"/> Communal Pool | <input checked="" type="checkbox"/> Games Room |
| <input checked="" type="checkbox"/> Gym | <input checked="" type="checkbox"/> Jacuzzi | <input checked="" type="checkbox"/> Views: Sea |
| <input checked="" type="checkbox"/> Key ready | <input checked="" type="checkbox"/> Near bus route | <input checked="" type="checkbox"/> gated |
| <input checked="" type="checkbox"/> Near Golf / Golf Resort Property | <input checked="" type="checkbox"/> Near Schools | <input checked="" type="checkbox"/> Double Bedrooms: 3 |
| <input checked="" type="checkbox"/> Near Trees | <input checked="" type="checkbox"/> Near Commercial Center | <input checked="" type="checkbox"/> Location: Coastal, Urbanisation |
| <input checked="" type="checkbox"/> Near Childrens Parks | <input checked="" type="checkbox"/> Elevator/Lift | <input checked="" type="checkbox"/> Air Conditioning: Yes |
| <input checked="" type="checkbox"/> Terrace: 56 Msq. | <input checked="" type="checkbox"/> Useable Build Space: 104 Msq. | <input checked="" type="checkbox"/> Beach: 450 Meters |