

## 2 Cuarto Apartamento en venta en Orihuela Costa, Alicante

240.000€

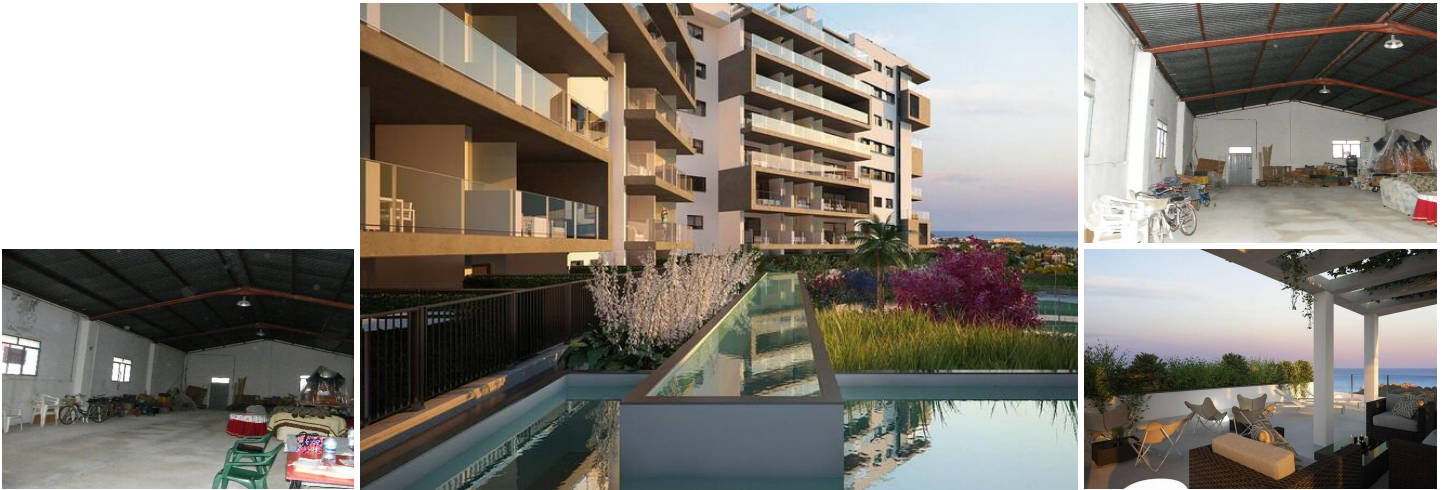

GROUND FLOOR FLAT IN LUXURY RESIDENTIAL COMPLEX NEXT TO THE SEA

Imagine a place where the sea and nature become the protagonists of an incredible story: yours. Imagine an environment where you can give free rein to your imagination and live a thousand adventures by land sea. Welcome to this new Residential in Campoamor, the home where you can live the life you have always dreamed of with the most beautiful horizon in the background: the Mediterranean.





Ground floor flat with garden, 2 bedrooms, with large terrace, kitchen equipped with modern appliances, the most exclusive details and communal areas designed for the enjoyment of the whole family. Living in this residential is to feel the Mediterranean in every room of the house.

The Residential is located in the highest part of Campoamor, very close to La Glea beach and the marina.

A contemporary and modern architectural design that offers exclusive homes with top quality finishes, fusing spaciousness and new technologies in terms of efficiency and construction.

Its imposing façade, the balance of its forms, the garden inside and the enormous terrace of the homes make this residential a beautiful architectural reference in the Mediterranean.

You will be able to enjoy green areas for strolling and sunbathing. The communal areas include a large indoor heated swimming pool, a chill out area on the roof terrace, as well as a sports area to enjoy outdoor exercise, a gym, a children's play area and a large outdoor swimming pool together with a smaller one for children and a gourmet room

- |  |   |  |
|--|---|--|
|  2 dormitorios                         |  2 baños |  101m <sup>2</sup> Tamaño de construcción |
|  16m <sup>2</sup> Tamaño de la parcela | <input checked="" type="checkbox"/> Piscina   | <input checked="" type="checkbox"/> Communal Pool  |
| <input checked="" type="checkbox"/> Gym  | <input checked="" type="checkbox"/> Parking   | <input checked="" type="checkbox"/> gated  |
| <input checked="" type="checkbox"/> Number of Parking Spaces: 1  | <input checked="" type="checkbox"/> Near Golf / Golf Resort Property                        | <input checked="" type="checkbox"/> Near Schools   |
| <input checked="" type="checkbox"/> Near Trees   | <input checked="" type="checkbox"/> Near Commercial Center                                  | <input checked="" type="checkbox"/> Double Bedrooms: 2   |
| <input checked="" type="checkbox"/> Solarium: Yes  | <input checked="" type="checkbox"/> Elevator/Lift   | <input checked="" type="checkbox"/> Beach: 1000 Meters   |
| <input checked="" type="checkbox"/> Location: Coastal, Rural, Urbanisation   | <input checked="" type="checkbox"/> Terrace: 24 Msq.  | <input checked="" type="checkbox"/> Useable Build Space: 65 Msq.   |
|  | <input checked="" type="checkbox"/> B   |  |