

4 Schlafzimmer Villa zu verkaufen in Finestrat, Alicante

678.000€

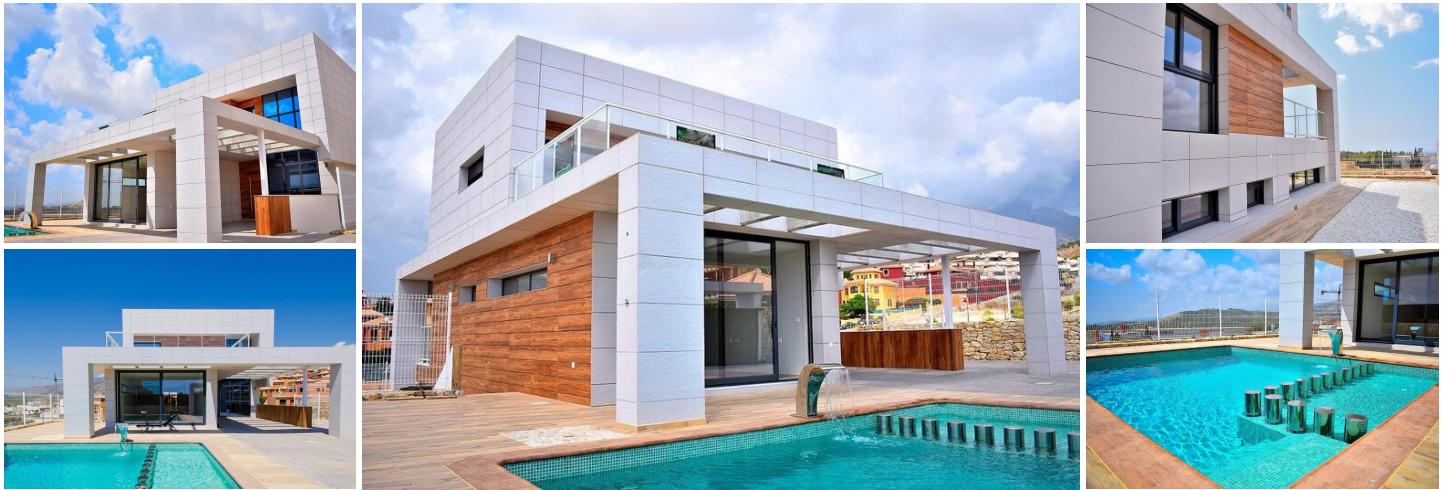

MODERN VILLA WITHIN WALKING DISTANCE TO BENIDORM!!!

This villa has been built with luxury finishes such as ventilated facade for greater thermal insulation and lower energy consumption and solarium.





High standing construction offering an avant-garde design, functional and elegant and elegant, comfortable spaces and high quality finishes.

Large plot and private swimming pool.

Its optimal orientation and its large windows allow the entry of natural light throughout the day. Its elevated and gently sloping position guarantees great sea views in the distance.

This is a luxury home with spacious, light-filled rooms and spaces designed to be lived in, open concept on the ground floor, with exceptional views, just a stone's throw from the sea and the mountains.

A dream of many... within the reach of a few.

- | | | |
|---|--|--|
|  4 Schlafzimmer |  4 Badezimmer |  206m ² Baugröße |
|  504m ² Grundstücksgröße | <input checked="" type="checkbox"/> Schwimmbad | <input checked="" type="checkbox"/> Private Pool |
| <input checked="" type="checkbox"/> Views: Sea | <input checked="" type="checkbox"/> Garden | <input checked="" type="checkbox"/> Near bus route |
| <input checked="" type="checkbox"/> gated | <input checked="" type="checkbox"/> Number of Parking Spaces: 1 | <input checked="" type="checkbox"/> Near Golf / Golf Resort Property |
| <input checked="" type="checkbox"/> Near Schools | <input checked="" type="checkbox"/> Air Conditioning: Pre-Installed | <input checked="" type="checkbox"/> Near Trees |
| <input checked="" type="checkbox"/> Near Commercial Center | <input checked="" type="checkbox"/> Beach: 4000 Meters | <input checked="" type="checkbox"/> Solarium: Yes |
| <input checked="" type="checkbox"/> Under-Build / Basement | <input checked="" type="checkbox"/> Double Bedrooms: 4 | <input checked="" type="checkbox"/> Terrace: 80 Msq. |
| <input checked="" type="checkbox"/> Location: Coastal, Rural, Mountain, Urbanisation | <input checked="" type="checkbox"/> Useable Build Space: 190 Msq. | <input checked="" type="checkbox"/> B |