

2 Schlafzimmer Appartement zu verkaufen in Pilar de la Horadada, Alicante

275.000€

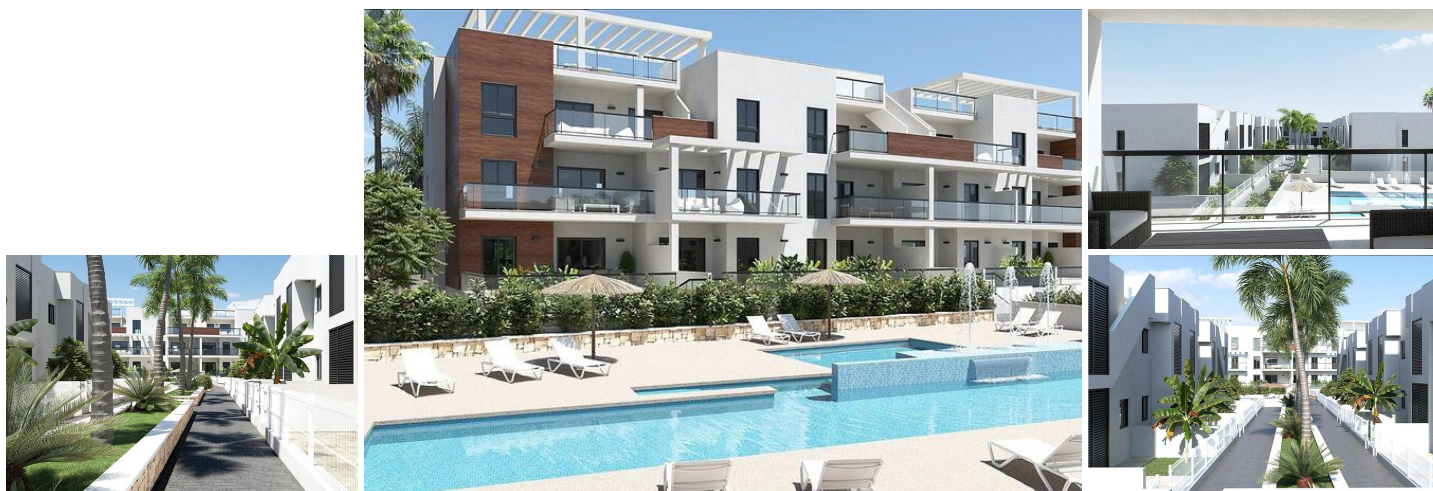

NEW BUILD RESIDENTIAL COMPLEX IN TORRE DE LA HORADADA

New Build residential complex of apartments, penthouses and bungalows with 2 and 3 bedrooms, 2 bathrooms in Torre de la Horadada only 300m from the beach.

Bungalows on the ground floor with private gardens, penthouses and bungalows on the top floor with private solarium.

All of them with fitted kitchen with high and low furniture. There is also a laundry area and pre-installation for air conditioning.

The residential complex consists of communal swimming pools and garden areas.

All properties has private parking.

Torre de la Horadada is located south of Alicante in a beautiful location on the coast.

The beautiful beaches of Torre de la Horadada and Mil Palmeras have fine sand beautiful promenade.

There are lots of restaurants, bars and shops, also water sports, diving and snorkelling.

It is well connected just 40 minutes from Alicante and Murcia's Converse airports, with large commercial shopping

- | | | |
|---|--|--|
| <input type="checkbox"/> 2 Schlafzimmer | <input type="checkbox"/> 2 Badezimmer | <input type="checkbox"/> 92m ² Baugröße |
| <input type="checkbox"/> 22m ² Grundstücksgröße | <input checked="" type="checkbox"/> Schwimmbad | <input checked="" type="checkbox"/> Communal Pool |
| <input checked="" type="checkbox"/> Garden | <input checked="" type="checkbox"/> Near bus route | <input checked="" type="checkbox"/> gated |
| <input checked="" type="checkbox"/> Number of Parking Spaces: 1 | <input checked="" type="checkbox"/> Near Golf / Golf Resort Property | <input checked="" type="checkbox"/> Near Schools |
| <input checked="" type="checkbox"/> Air Conditioning: Pre-Installed | <input checked="" type="checkbox"/> Near Trees | <input checked="" type="checkbox"/> Near Commercial Center |
| <input checked="" type="checkbox"/> Double Bedrooms: 2 | <input checked="" type="checkbox"/> Location: Coastal, Urbanisation | <input checked="" type="checkbox"/> Beach: 300 Meters |
| <input checked="" type="checkbox"/> Useable Build Space: 67 Msq. | <input checked="" type="checkbox"/> Terrace: 19 Msq. | <input checked="" type="checkbox"/> B |