

## 3 soveværelse Lejlighed til salg i Benalmadena, Málaga

704.000€

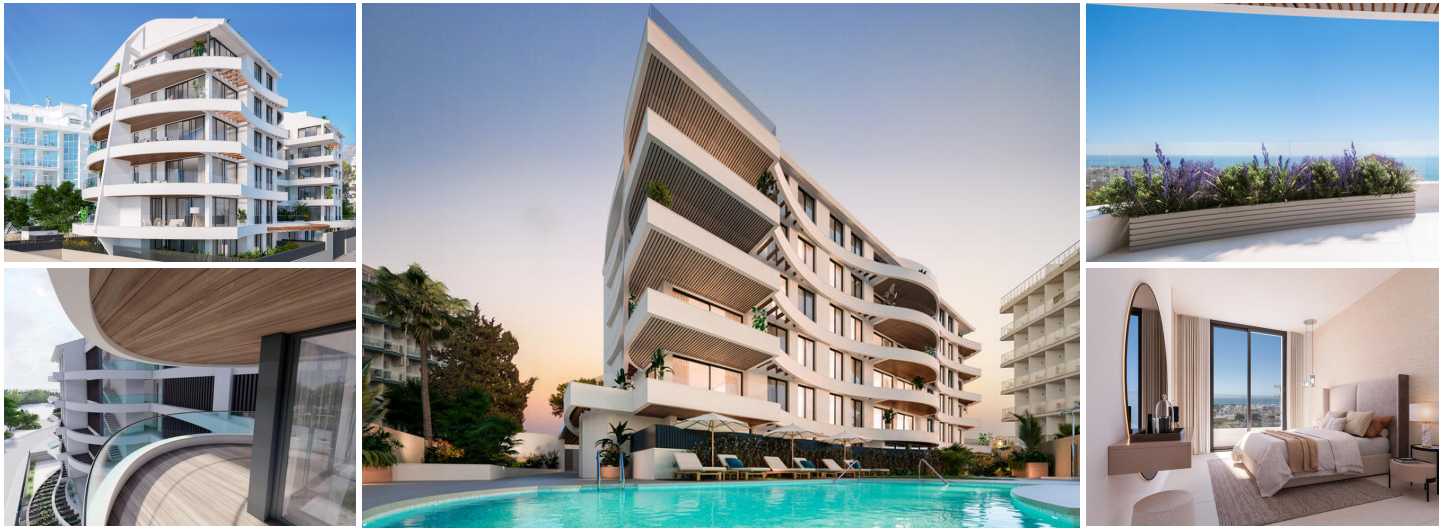

Nestled amidst Benalmadena's vibrant centre and situated adjacent to its picturesque port, this luxury resort offers the perfect blend of city living and seaside luxury. A distinctive project that will house 33 properties in total with 3 bedrooms where elegance meets the horizon. Parking space and storage room are also included!

The architectural project of this complex is ambitious and captivating, standing out for its design and functionality. In addition, the communal areas have been carefully designed to provide the perfect space to relax and enjoy, while maintaining privacy.

Adjacent to the complex is Puerto Marina, one of the most popular attractions on the Costa del Sol. With a wide range of leisure and entertainment on offer, this charming marina is the perfect place to entertain the whole family.

Furthermore, just a 10-minute walk away, you can enjoy the largest and most popular beach in the area. The Torrebermeja and Malapesquera beach, more than 700 metres long and 50 metres wide, has excellent facilities and a wide range of cultural and entertainment activities.

Located between the towns of Torremolinos and Fuengirola, Benalmadena is just 20 minutes from Malaga airport and is connected to the main areas and attractions of the coast by train and bus services. Rich in attractive beaches, numerous entertainment options and an impressive marina, Benalmadena is one of the most popular destinations on the Costa del Sol.

The area adjacent to the coast is known as Benalmádena Costa. This location, besides being perfectly communicated to Malaga and Torremolinos, boasts excellent beaches, a leisure area in Puerto Marina, a casino, golf courses

- |   |  |  |
|---|--|--|
|  3 soveværelser                   |  2 badeværelser |  72m <sup>2</sup> Byg størrelse |
|  100m <sup>2</sup> Grundstørrelse | <input checked="" type="checkbox"/> Svømmepøl  | <input checked="" type="checkbox"/> Modern   |
| <input checked="" type="checkbox"/> Near beach  | <input checked="" type="checkbox"/> Near town  | <input checked="" type="checkbox"/> Near city  |
| <input checked="" type="checkbox"/> Near airport  | <input checked="" type="checkbox"/> Near golf  | <input checked="" type="checkbox"/> Near schools   |
| <input checked="" type="checkbox"/> Near hospital   | <input checked="" type="checkbox"/> Sea views  | <input checked="" type="checkbox"/> City views   |
| <input checked="" type="checkbox"/> Air conditioning  | <input checked="" type="checkbox"/> Underfloor Heating   | <input checked="" type="checkbox"/> Superfast Fiber Internet   |
| <input checked="" type="checkbox"/> Off road parking  | <input checked="" type="checkbox"/> Lift   | <input checked="" type="checkbox"/> Disabled Access  |
| <input checked="" type="checkbox"/> Level plot  | <input checked="" type="checkbox"/> One-floor  |  |