

New development in a magnificent residential area and in an extraordinary location.
 . Th-bbbu

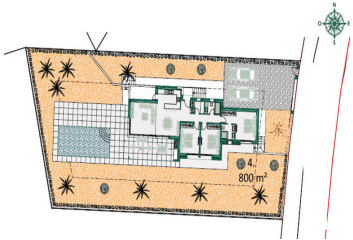

New development in a magnificent residential area and in an extraordinary location.

The two and three-bedroom apartments are distributed in different blocks resulting in a balanced ensemble. The project combines a modern design architecture wrapped with a perfectly studied landscaping that surrounds the building with its large gardens and common leisure areas that allow the client to enjoy a resort concept.

Very spacious apartments, penthouses and ground floors with distributions, qualities and finishes designed so that the property is just what you are looking for.

Every apartment has a large terrace, a key part of the entire apartment, a spacious extension with magnificent views. The location and the environment are great with unbeatable views of the Mediterranean Sea.

Manilva is a unique town due to its location, culture and gastronomy, a place to enjoy the sun, the sea and a nice and friendly lifestyle.

The spacious common areas have been designed to offer a wide range of amenities, services and fun for everyone. Your exclusive home in a private resort with large gardens with pools with saline chlorination, solarium, relaxation and yoga area, spa with Turkish bath, jacuzzi and sauna, indoor fitness area, leisure room with coworking, multimedia and games area, all surrounded by gardens with landscape treatment and picnic area.

The units have been designed with an ideal layout with large spaces and terraces designed to be an extension of the apartment. The orientation of the development and its strategic location allow the views and the sun to be the main

- | | | |
|---|--|---|
| <input type="checkbox"/> 2 soveværelser | <input type="checkbox"/> 2 badeværelser | <input type="checkbox"/> 89m ² Byg størrelse |
| <input checked="" type="checkbox"/> Svømmepøl | <input checked="" type="checkbox"/> South-east orientation | <input checked="" type="checkbox"/> 46 m ² terrace |
| <input checked="" type="checkbox"/> Communal garage | <input checked="" type="checkbox"/> Communal garden | <input checked="" type="checkbox"/> Communal pool |
| <input checked="" type="checkbox"/> Amenities near | <input checked="" type="checkbox"/> Air conditioning | <input checked="" type="checkbox"/> Fully fitted kitchen |
| <input checked="" type="checkbox"/> Utility room | <input checked="" type="checkbox"/> Gym | <input checked="" type="checkbox"/> Double glazing |
| <input checked="" type="checkbox"/> Brand new | <input checked="" type="checkbox"/> Private terrace | <input checked="" type="checkbox"/> Sea view |
| <input checked="" type="checkbox"/> Country view | <input checked="" type="checkbox"/> Mountain view | <input checked="" type="checkbox"/> Internet - Wi-Fi |
| <input checked="" type="checkbox"/> Covered terrace | <input checked="" type="checkbox"/> Fitted wardrobes | <input checked="" type="checkbox"/> Gated community |