

## 3 soveværelse Lejlighed til salg i Marbella, Málaga

709.500€

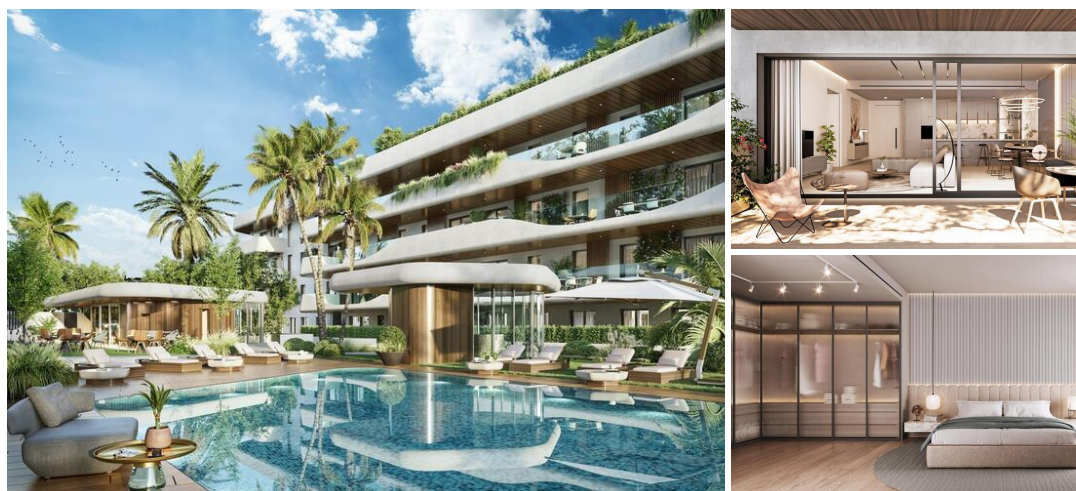

Allow us to introduce you to a new standard of living in our unbeatable new project, carefully designed to offer you the best in comfort, functionality, and location.

This new development is strategically located in the heart of San Pedro, ensuring that everything you need is just a few steps away. From supermarkets, shops, and pharmacies to medical services, as well as one of the best tennis and paddle clubs in the area, golf courses, restaurants, and beach clubs. The apartments will be built with top-quality materials and finishes, featuring open and well-lit living areas.

With 2, 3, and 4 bedrooms, apartments, and penthouses, with spacious interiors of up to 195 m<sup>2</sup> and fabulous terraces of up to 189 m<sup>2</sup>, each apartment is a testament to contemporary design and elegance. All homes will have at least one parking space and storage room included in the price, and all apartments can be customized to the buyer's preferences.

Our common areas are no less impressive, allowing you to immerse yourself in state-of-the-art facilities, such as a dedicated co-working space for the modern professional, electric vehicle charging points for environmentally conscious clients, a heated indoor pool, and a fully equipped gym and spa. The complex will be completely gated, with security entrance and control gate.

In summary, this development stands out as the best project in the area due to its unique and avant-garde design that combines aesthetics and functionality exceptionally. Join us and experience a new level of unbeatable living!

- |  |   |  |
|--|---|--|
| 3 soveværelser                                       | 2 badeværelser  | 113m <sup>2</sup> Byg størrelse                        |
| <input checked="" type="checkbox"/> Svømmepøl        | <input checked="" type="checkbox"/> a estrenar          | <input checked="" type="checkbox"/> aire acondicionado |
| <input checked="" type="checkbox"/> alto standing    | <input checked="" type="checkbox"/> armarios empotrados | <input checked="" type="checkbox"/> ascensor           |
| <input checked="" type="checkbox"/> cocina americana | <input checked="" type="checkbox"/> cocina amueblada    | <input checked="" type="checkbox"/> cocina equipada    |
| <input checked="" type="checkbox"/> exterior         | <input checked="" type="checkbox"/> gimnasio            | <input checked="" type="checkbox"/> jardín comunitario |
| <input checked="" type="checkbox"/> lavadero         | <input checked="" type="checkbox"/> luminoso            | <input checked="" type="checkbox"/> obra nueva         |
| <input checked="" type="checkbox"/> parking          | <input checked="" type="checkbox"/> piscina comunitaria | <input checked="" type="checkbox"/> sauna              |
| <input checked="" type="checkbox"/> terraza          | <input checked="" type="checkbox"/> trastero            |  |